

PINTOS

使用说明  
USER MANUAL

1. 室外执手

正常开门：轻按执手内侧暗藏按钮，即可自动开门。

反锁状态：当室内反锁时，室外按下按钮将亮起红色灯光警示，无法开启。

应急开锁：如遇紧急情况，可取下盖板使用应急钥匙插入应急孔，顺时针旋转即可解锁。

2. 室内执手

一键反锁：长按执手内侧暗藏按钮3秒，直至红灯亮起，即可反锁。

快速解锁：反锁状态下，只需轻按执手内侧暗藏按钮一下，绿灯亮起，门锁将自动解锁。

User Manual:

1. Outdoor Handle

Normal door opening: Press the hidden button on the inner side of the handle lightly to open the door automatically.

Locked state: When the door is locked from the inside, pressing the button outdoors will trigger a red light warning, and the door cannot be opened.

Emergency unlocking: In case of emergency, remove the cover, insert the emergency key into the emergency hole, and rotate clockwise to unlock.

2. Indoor Handle

One-touch locking: Press and hold the hidden button on the inner side of the handle for 3 seconds until the red light turns on to lock the door.

Quick unlocking: In the locked state, simply press the hidden button on the inner side of the handle once; the green light will turn on, and the door lock will unlock automatically.

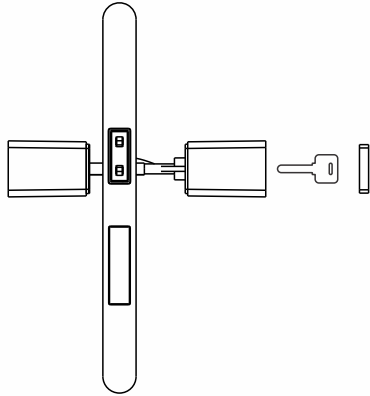

安装步骤  
INSTALLATION  
STEPS

1.安装锁体：

根据定位纸卡，在门及门框上开好门锁与锁体对应的孔位。

将锁体上的两条连接线从卡扣中解开。将锁体放入对应的安装孔，并将两条线穿过门锁孔。注意白色线头朝外，红色线头朝内。

注意！内执手的孔位下方需预留线槽，随后拧紧锁体固定螺丝。

取出扣盒，将其上两个定位螺丝稍作松动。将扣盒安装至门框对应位置，并拧紧螺丝固定。

1. Install the lock body:

According to the positioning paper card, drill holes in the door and door frame corresponding to the door lock and lock body.

Unfasten the two connecting wires on the lock body from the clips. Place the lock body into the corresponding installation hole, and pass the two wires through the door lock hole. Note that the white wire end should face outward, and the red wire end inward.

Attention! A wire slot needs to be reserved under the hole of the inner handle, then tighten the lock body fixing screws.

Take out the strike box, slightly loosen its two positioning screws. Install the strike box at the corresponding position on the door frame, and tighten the screws to fix it.

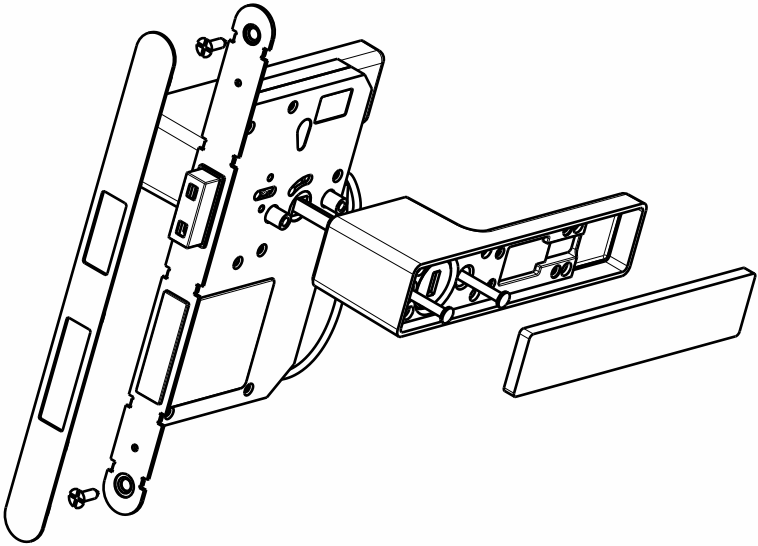
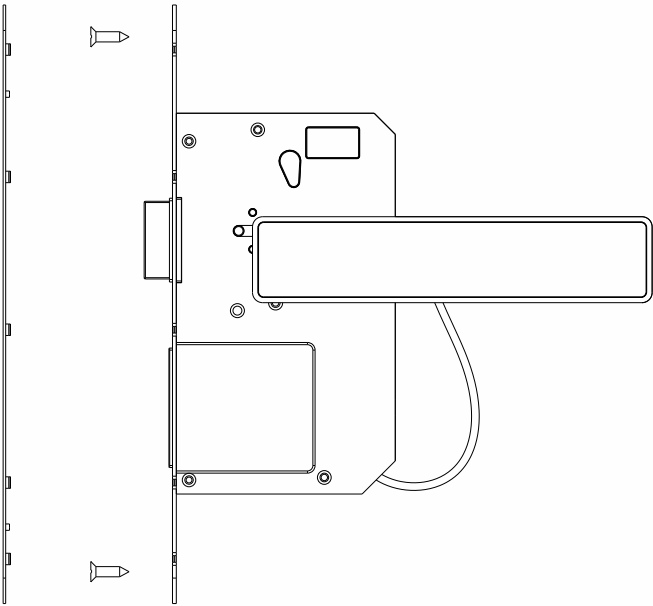

2.安装执手：

将外执手接好连接管，插好白色连接线，锁芯传动片按门厚调节长短后（用老虎钳可折断）保持垂直方向插入锁体内。取下后盖板，安转对装螺丝，调直前后执手位置至水平状态后用力拧紧。安装完成后，请多次开合门板，测试是否顺畅。如因槽口厚度影响，可适当调节扣板螺丝松紧。确认无误，安装装饰片。

2.Install the handle:

Connect the external handle to the connecting pipe, insert the white connecting wire, adjust the length of the lock cylinder transmission plate according to the door thickness (can be broken with pliers), and insert it vertically into the lock body. Remove the rear cover plate, install the counter-installation screws, adjust the front and rear handles to a horizontal position, and tighten them firmly. After installation, open and close the door panel multiple times to test if it operates smoothly. If affected by the thickness of the notch, appropriately adjust the tightness of the buckle plate screws. Once confirmed correct, install the decorative plate.

3.安装电池：

取下锁体电池仓，装入电池（注意电池正极朝上，与仓内图标一致），将电池仓装回锁体，并安装好装饰片。

3.Install the batteries:

Remove the battery compartment from the lock body, insert the batteries (note that the positive poles of the batteries should face upward, aligning with the icons inside the compartment).

Put the battery compartment back into the lock body and install the decorative plate properly.

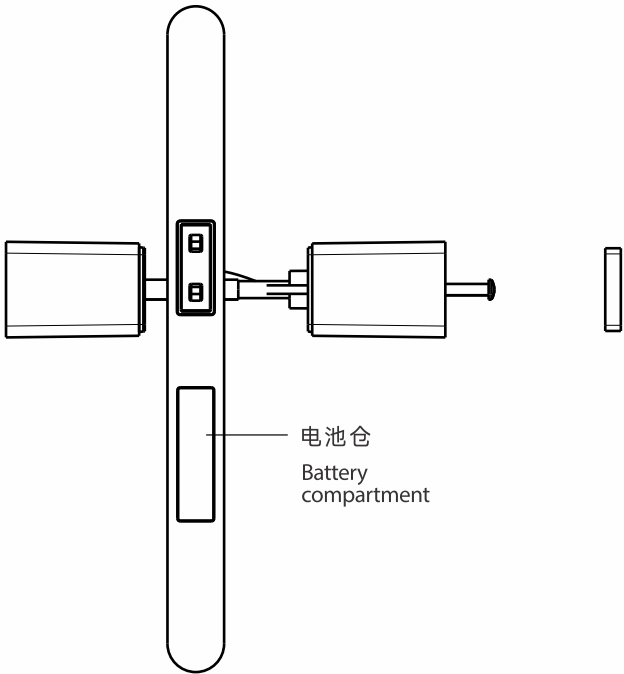

PINTOS 品多智能锁

安装视频